

S REMOVABLE SPEED BUMP

Code: R-S-81-QP

WHAT'S A REMOVABLE SPEED BUMP?



The removable speed bump is a device that helps to reduce the speed of drivers on the asphalt surface for temporary events or works, this can be placed, used and removed easily.

The main function of this device is to decrease the speed of motorists in a possible police checkpoint or any other circumstance.

Mainly suggested in schools, checkpoints, breathalyzer tests, hospital zones or places where is necessary to slow down.

FEATURES

- The effectiveness of the R-S-81QP is due to its modular design, which is removable and can be used in temporary situations.
- Its dynamic shape transforms it into a friendly speed bump for the city.
- Manufactured in polyethylene, material that avoids any damage on vehicles.
- The anti slip surface creates a safer device.
- Resists up to 771,161 lbs.
- Ideal to place in zones and times with greater traffic flow or to hold transit.
- Line colors: black and yellow with great durability.
- It is easily installed, screws are not required and its join is made of steel plates in arrow shape.
- It has the option to include light.
- For its functionality with light, this is composed by LEDs road stud that provide a greater visibility at night.

SOLAR ROAD STUD

- Road stud with intelligent solar system.
- Solar panel and highly efficient electronic system.
- LED's in transparent amber or blue color with 30 degree beam angle.
- 3 Hz flashing frequency.

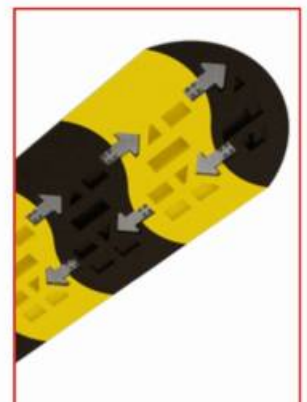

S REMOVABLE SPEED BUMP

Code: R-S-81-QP

MEASUREMENTS

Dimensions and other measures are nominal and may vary by +/- 2%.

- Generales**
 - Center: 15.7 in x 23.6 in
 - End Caps: 9.8 in x 23.6 in
 - Height: 2.7 in
- Functional**
 - Center: 11.8 in x 23.6 in
 - 1 End Cap: 9.8 in x 23.6 in
 - 2 End Cap: 5.9 in x 23.6 in
- Reflector**
 - Road Studs (optional)
- LED color**
 - Amber or blue

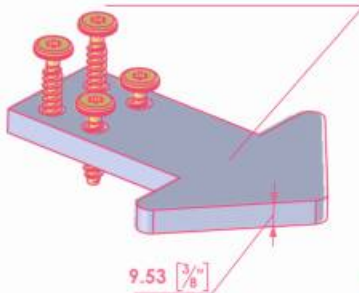

Join of speed bump without anchors and through steel plates in arrow shape of 9.53 mm (3/8") and 4 self tapping screws.

