

SOLAR SPEED BUMP RDV-45

Code: RDV-45 S



WHAT'S A SPEED BUMP?

Device installed on asphalt surfaces to maintain a reduced speed on certain sections of the road.

Its main function is reducing speed of drivers.

Mainly suggested on schools, pedestrian crossings, hospital areas, and necessary places to slow down.

FEATURES

- The technology used on the manufacture of the RDV-45 S is the highest on design and materials, accomplishing its function, with great resistance and durability.
- Its dynamic shape creates a friendly speed bump for big cities.
- Male-Female assembly with end caps.
- Manufactured in polyethylene, avoiding damage to vehicles.
- Every piece is made in solid colors, preventing discolor of black and yellow colors.
- Option to have light.
- Its light functioning is composed by solar spheres to optimize the visibility of drivers during nighttime.
- Easy to install, with steel anchors (not included). Each piece has boreholes for convenient installation.

LIGHTING SYSTEM

- Colorless polycarbonate spheres.
- Smart Solar System.
- JVM circuit for flashing mode and able to synchronize up to 98 ft.
- Solar panel and high efficiency electronic system.
- Ultra-bright LEDs in pink, amber, blue, white or red.

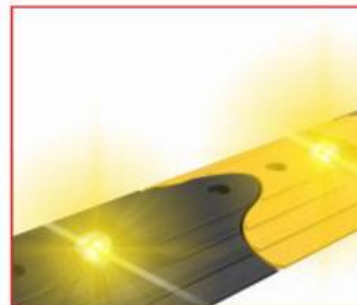

SOLAR SPEED BUMP RDV-45

Code: RDV-45 S

MEASUREMENTS

Dimensions, and other measures are nominal and may vary by +/- 2%.

Measurements:

- **Female End Cap**
Dimension: 10.9 in
Weight: 3.0 lb
- **Center Section**
Dimension: 22.2 in
Weight: 7.0 lb
- **Male End Cap**
Dimension: 6.4 in
Weight: 2.7 lb
Width: 11.8 in
Length: 2.5 in

Pressure Resistance:

- 170680.12 lb x in²

LED Color:

- Pink, amber, blue or red.

ANCHORING

1. Mark the boreholes using the speed bump as a guide.
 2. Drill with a ½" drill bit for concrete to a depth of 10".
 3. Assemble the speed bump and insert the anchors, then with the help of a mallet, hit until it reaches the end.
- Note:** Fill the holes with epoxy glue for better fastening.



FRONT VIEW

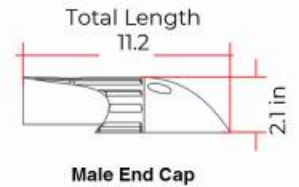
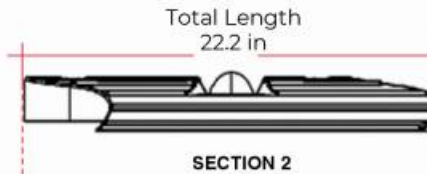
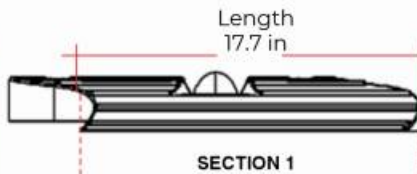
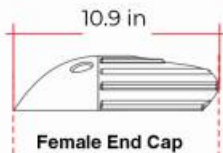

UPPER VIEW

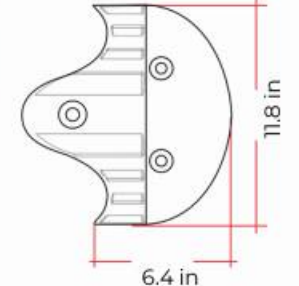
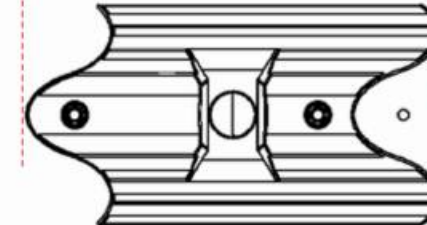
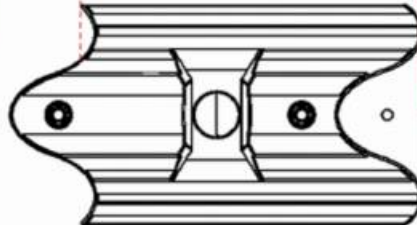
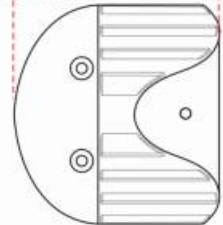

EXAMPLE OF DIMENSIONS 10.3 ft X 11.8 in

