

GLOBAL FORTE SIGN 86

Code: SE-BA-6076



**WE HAVE PASSED...
TO THE NEXT LEVEL**

FEATURES

- Boards designed in accordance with the 034-SCT2 to guarantee visibility and compliance of traffic regulations.
- Integrates latest generation LEDs, maximizing visibility with many combinations.
- Supported on one or two Posteflex® that guarantees resistance to adverse climate conditions; includes grips of black polyethylene and screws for a safe fastening.
- Optimal size for signs to be identified at distance.
- In addition, it can turn to 45° and be a warning sign.
- It also has 4 optional LEDs per end, increasing visibility.
- Types of signs: warning: it warns about possible risks. Restrictive: indicate prohibitions or limitations on transit. Temporary traffic control: inform about works on roads. Recreation: sign points of interest and services. Service: indicate available services in the zone. Safety: for emergency situations.
- **IP68 waterproof electronic system.**

TECHNICAL FEATURES

- Manufactured in black polymer with one side.
- With Posteflex® in yellow or grey color.
- Resistance to inclemency and temperature changes, with UV protection.
- Anti-humidity and recyclable; long life-span, due it doesn't rusts.
- Vandal-proof, polymer material has zero resale value neither work for other uses, avoiding thefts.
- Stackable, reducing transportation and storage costs.
- Easy installation; Posteflex® with tubular reinforcement on its interior or RHS of steel.

SOLAR SYSTEMS

- Solar power supply panel at top part.
- LEDs with optics with mirrors, causing expands much better the light in all the sign.
- 12 V batteries.
- JVM power supply electronic circuit that synchronizes flashing of signs at the same time.
- It charges during 5 hours under sun, it lasts 12 hours On in flashing mode.



GLOBAL FORTE SIGN 86

Code: SE-BA-6076

MEASURES

Dimensions and other measures are nominal and may vary by + - 2 %.

General

- Length: 33.0 in
- Width: 2.7 in
- Height: 33.0 in

Vinyl

- Length: 33.8 in
- Height: 33.8 in

Diamond

- Length: 46.8 in
- Height: 46.8 in

Reflective mat.

- Depends on the design
- Width: 1.9 x 1.9 in
- Length: 13.1 ft
- Thickness: 0.19 in

Posteflex®

- Width: 1.9 x 1.9 in
- Length: 9.8 ft
- Thickness: 0.11 in

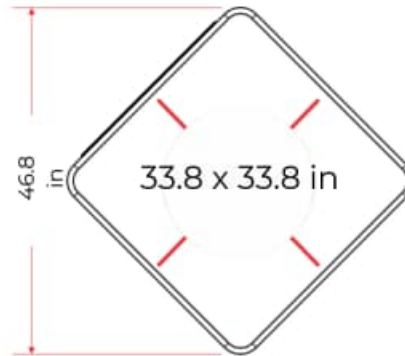
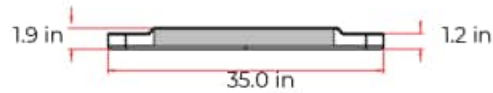

POSTEFLEX®

Height

In urban and rural roads, the lower part of the signs must be 8.2 ft above sidewalk level.

Embed

Leave 19.6 in to embed



GLOBAL FORTE SIGN 86

Code: SE-BA-6076

MODES



LABEL

Restrictive: Reflective background "A or B" type, as required; in white color, texts and fillet in opaque black vinyl, ring in red color.

Warning: Reflective background "A or B" type, as required; in yellow color, texts and fillet in opaque black vinyl.

Recreation: Reflective background "A or B" type, as required; in blue or brown color, texts and fillet in opaque white vinyl.

Service: Reflective background "A or B" type, as required, in blue color, texts and fillet in opaque white vinyl.

Temporary traffic control: Reflective background "A or B" type, as required, in orange color, texts and fillet in opaque black vinyl.

Guaranteed vinyl adherence.

Note: It can customize with institution logo, if desired, this is printed digitally.